

Residual Current Operated Circuit Breaker With Intergral Overcurrent Protection (RCBO) ML32-1 Series 6kA



ML32-1



Type AC	rating (A)	cat. no. 10mA	cat. no. 30mA	cat. no. 100mA
B Curve	6	R0601B	R0603B	R0610B
	10	R1001B	R1003B	R1010B
	16	R1601B	R1603B	R1610B
	20	R2001B	R2003B	R2010B
	25	R2501B	R2503B	R2510B
	32	R3201B	R3203B	R3210B

Type AC	rating (A)	cat. no. 10mA	cat. no. 30mA	cat. no. 100mA
C Curve	6	R0601C	R0603C	R0610C
	10	R1001C	R1003C	R1010C
	16	R1601C	R1603C	R1610C
	20	R2001C	R2003C	R2010C
	25	R2501C	R2503C	R2510C
	32	R3201C	R3203C	R3210C

Type AC	rating (A)	cat. no. 10mA	cat. no. 30mA	cat. no. 100mA
B Curve	6	R0601BA	R0603BA	R0610BA
	10	R1001BA	R1003BA	R1010BA
	16	R1601BA	R1603BA	R1610BA
	20	R2001BA	R2003BA	R2010BA
	25	R2501BA	R2503BA	R2510BA
	32	R3201BA	R3203BA	R3210BA

Type AC	rating (A)	cat. no. 10mA	cat. no. 30mA	cat. no. 100mA
C Curve	6	R0601CA	R0603CA	R0610CA
	10	R1001CA	R1003CA	R1010CA
	16	R1601CA	R1603CA	R1610CA
	20	R2001CA	R2003CA	R2010CA
	25	R2501CA	R2503CA	R2510CA
	32	R3201CA	R3203CA	R3210CA

Technical Data

Description

- To protect individual circuit against overload, short circuit and earth leakage faults.
- Use in domestic, commercial and light industrial application.
- Compact and easy installation.

Electrical

Design according to	IEC 61009-1/ IEC 61009-2-2
Rated voltage (Ue)	240V~
Rated current (In)	6-32A
Frequency	50/60Hz
Tripping curve	B, C (IEC60898-1)
Energy limiting class	3
Rated breaking capacity (Icn)	6kA
RCD characteristics	Type A, Type AC (IEC 61008-2-2)
Rated sensitivity current (IΔn)	10, 30, 100mA
Degree of protection	IP20
Electrical and mechanical endurance	≥2000 operating cycles

Mechanical

Terminal capacity	1-10 mm ²
Mounting installation	DIN rail 50022

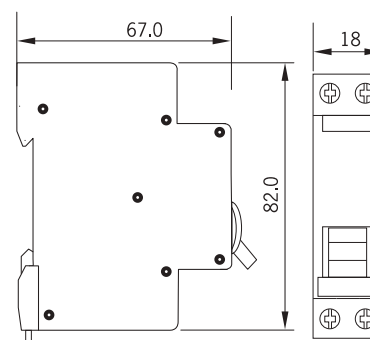

Change over switch



Type	rating 40A	cat. no.
1P		COS140
2P		COS240
3P		COS340

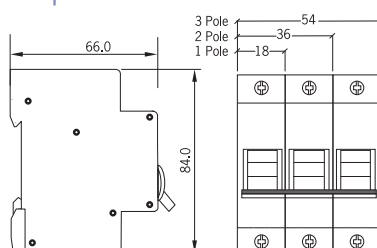

Technical Data

Electrical

Design according to	IEC 60947-3
Rated voltage (Ue)	240V/415V~
Rated current (In)	40A
No. of poles	1,2,3
Frequency	50/60Hz
Degree of protection	IP20
Utilization category	AC22B
Short time withstand current	10 In (1s)

Mechanical

Terminal capacity	1-10 mm ²
Rated current	40A
Mounting installation	DIN rail 50022

